

# JJ'S LIVE

## TECH PACK



**JJ'S LIVE**  
**3615 N STEELE BLVD**  
**FAYETTEVILLE, AR 72703**

**GENERAL MANAGER**  
**ZOE JOHNSON**  
**ZOE@JJSLIVE.COM**  
**(913) 952-2057**

**PRODUCTION MANAGER**  
**NICK CALDWELL**  
**NICK@JJSLIVE.COM**  
**(479) 221-5892**

# VENUE LAYOUT

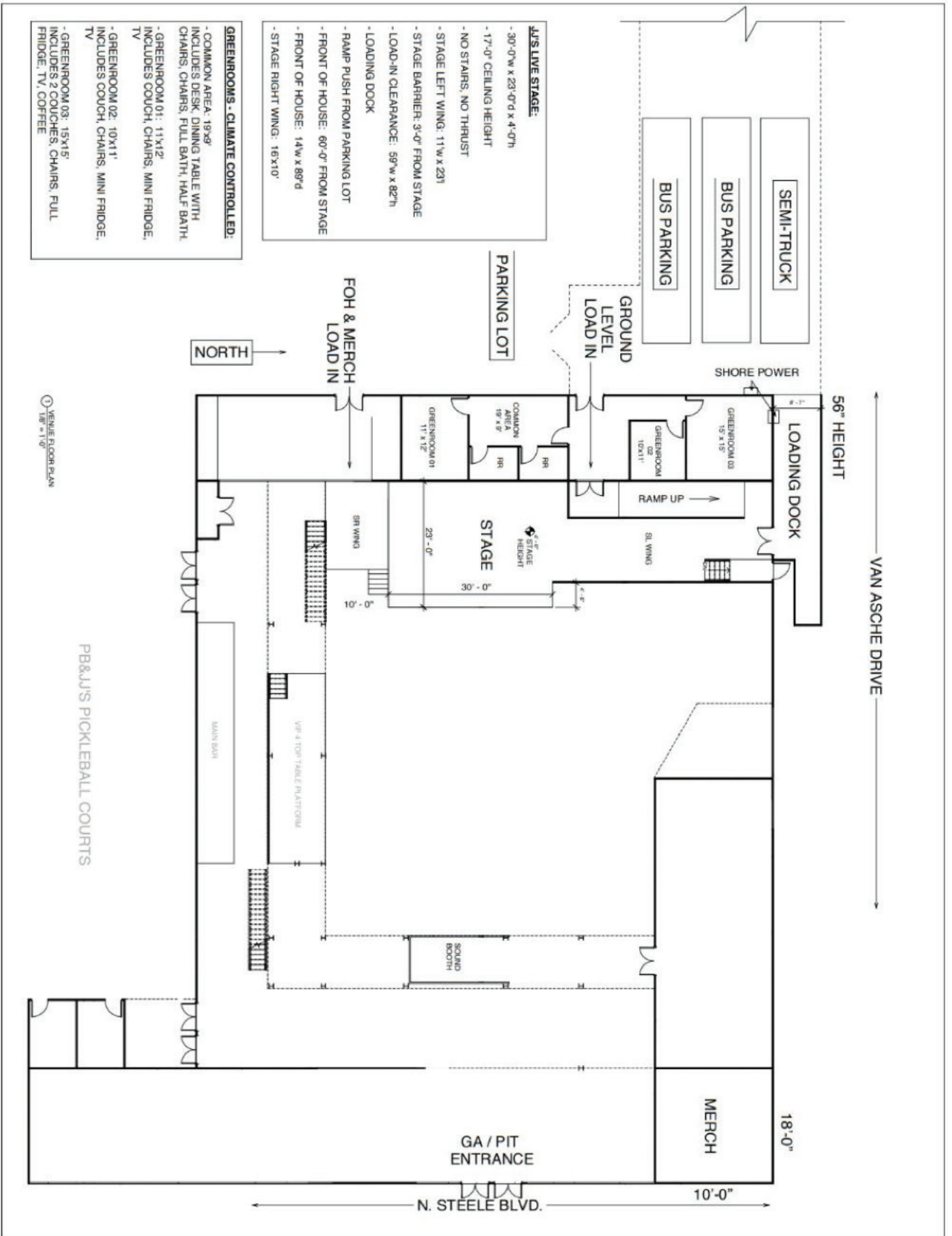



(2) Shore Power connections in bus parking area + loading dock to stage



# HOUSE AUDIO TECH SPECS

**Audio Power Connect:** 100 AMP 3-Phase Camlock Tie-In  
**FOH drive lines preferred (Left, Right, Subs, Fills)**

**FOH (mains):** (10) JBL VTX-V20 (5 Per side)

**FOH (subs):** (8) JBL SRX728S Dual 18" Subs

**FOH (front fills):** (4) JBL AC28/26

**Stage Monitors:** (6) VRX 915M

**FOH system amplifiers:** Crown I-Tech HD series

**Monitor amplifiers:** Crown XTi-6002

**FOH console:** Yamaha CL5

**MONITOR console:** Yamaha QL1 or QL5

**Stage Inputs:** 32 inputs (2) Yamaha Rio-1608

**3 guest shielded CAT-6 lines available**

**House Mic Package:**

(1) Shure Beta 91

(1) Shure Beta 52

(2) Shure Beta 181

Shure Beta 57

Shure SM58

Shure SM57

(1) Audix D6

(2) Sennheiser e609

(4) Sennheiser e904

(1) AKG C451 B

**DI Boxes:**

(3) BSS active DI

(2) DBX DI

XLR cables

**Mic Stands:**

(7) Tripod Tall Booms

(4) Heavy Base

Tall Booms

(7) Short Booms

**Subsnakes:**

(1) 12 channel

(2) 8 channel

**Drum Risers:**

(2) 8'x8'x1' -OR-

(1) 8'x8'x2' & (1) 8'x8'x1'

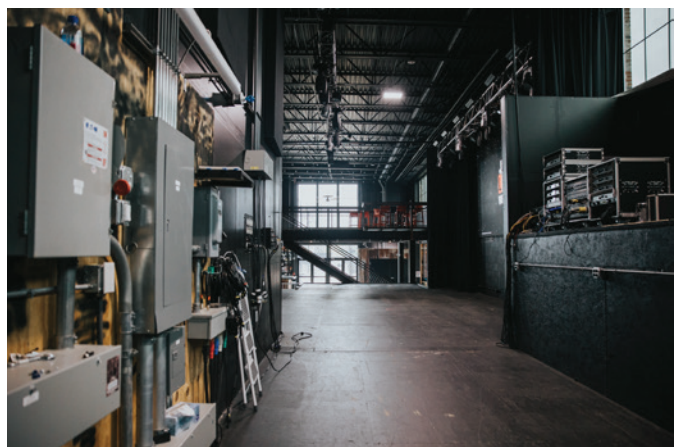
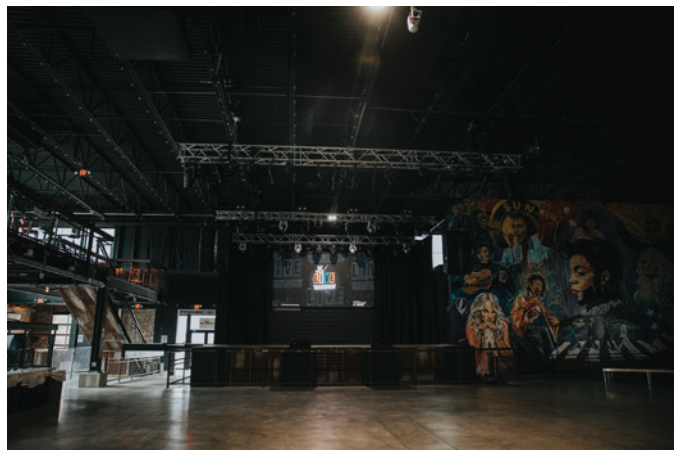

# HOUSE LIGHTING TECH SPECS

**LIGHTING POWER CONNECT:** 200 amp 3-phase camlock tie-in

## **FRONT OF HOUSE TRUSS**

- (2) Elation Fuze Spot
- (8) Elation SixPar 200IP
- (7) ETC Source Four Lekos
- (3) 26 degree source 4 lenses
- (4) 19 degree source 4 lenses

## **MIDSTAGE TRUSS**

- (6) Elation Platinum Beam 5R Extreme
- (4) Elation Cuepix Blinder WW2
- (4) Elation SixPar 200IP
- (2) Elation Fuze wash Z120

## **UPSTAGE**

- (6) Elation Platinum 5R Extreme
- (6) Elation SixPar 200IP
- (4) Fuze wash Z120
- (6) Elation ACL Bar

## **FLOOR PACKAGE 1 (ON CASTERS)**

- (2) Elation Platinum 5R Extreme
- (2) Elation ACL Bar

## **FLOOR PACKAGE 2 (ON CASTERS)**

- (2) Elation Platinum 5R Extreme
- (2) Elation ACL Bar

## **HAZER**

ADJ Entourage

## **LIGHTING CONSOLE-DATA**

GrandMA2 Command Wing with  
Touchscreen PC

All lighting is controlled by sACN

## **NODE**

Netron EN12 - located on stage left.



# LIGHTING DIAGRAM

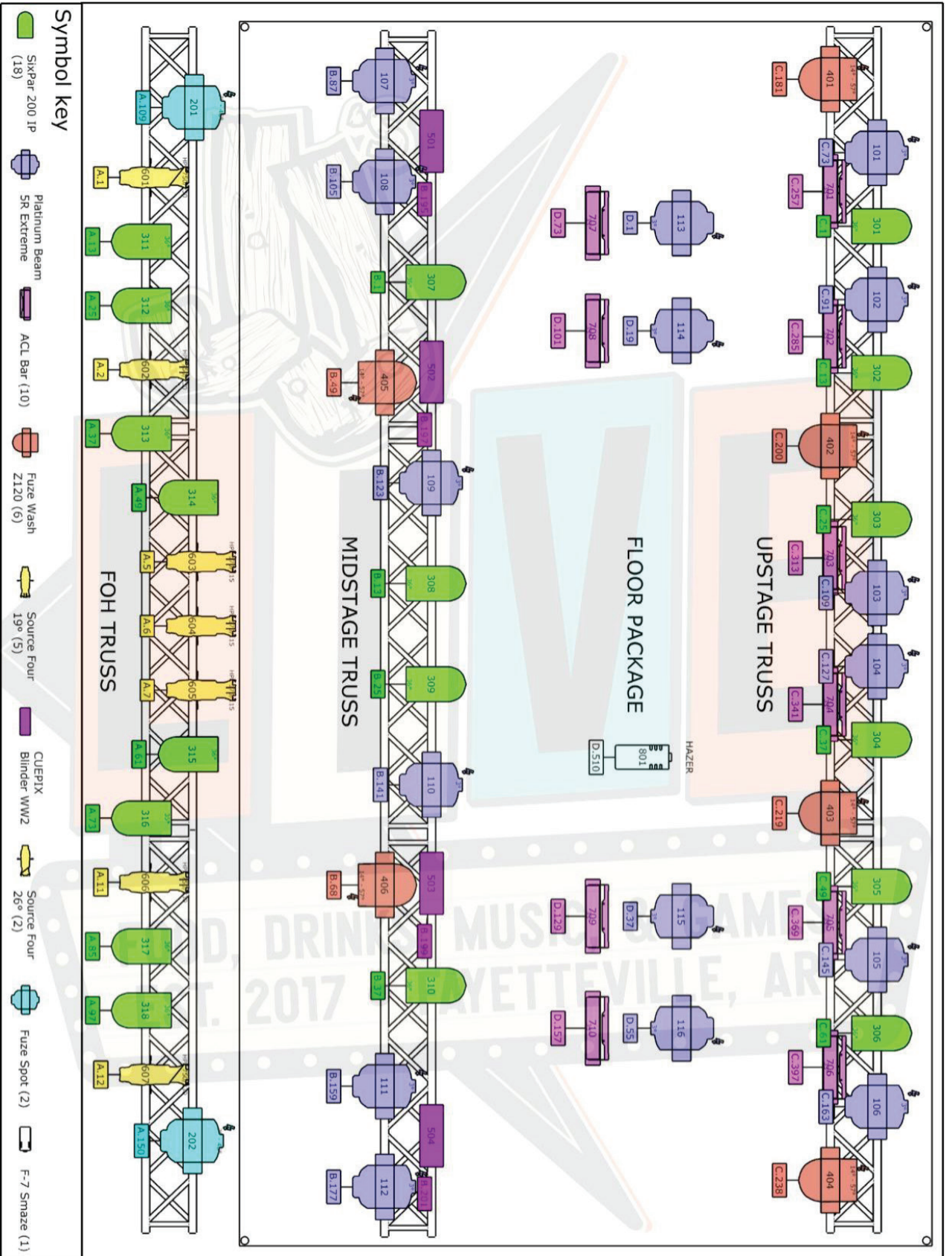

# STAGE TECH SPECS



**Stage Dimensions:** 30ft. W x 23ft. D x 4ft. H

**Stage Left Wing:** 10ft. W x 15ft. D

**Stage Right Wing:** 10ft. W x 16ft. D x 4ft. H

## **UPSTAGE VIDEO WALL:**

Black Dog Video 2.8mm 16.4ft x 9.02ft (1760 x 968)

**Processor:** Novastar VX6S

**Media Server:** Resolume Arena 7

**Inputs:** HDMI and SDI at FOH and stage (2) SDI runs from FOH to stage

